

Location Opportunity  
DOES NOT  
knock door everytime....!!!



## WAREHOUSE PLOTS at the lap of MUNDRA - ADANI PORT & SEZ

Ambaji Park - Warehouses PLOTS - offers exceptional value in a prime location within Mundra Port limits. This spacious, newly refurbished landmark arena is ideally located with high visibility and easy highway access.

Ambaji Park - Warehouses PLOTS, answers a pressing requirements for large-scale WAREHOUSEING space in Mundra. With total 4,01,368 sf of modern space can service a wide variety of commercial business needs.

An A Class location at affordable rates, Ambaji Park - Warehouses - is promoted and launched by industry-leading Ambaji Group - Properties.

Ambaji Park - Warehouses PLOTS - has it all: Location, Quality, Flexibility and Affordability, plus the large-scale storage space Mundra needs.

- LOCATION
- QUALITY
- FLEXIBILITY



*Building Community*



## The way forward

Warehousing forms an important constituent of the supply chain as it is where manufactured, imported or export goods are collected, stored and distributed to the point of consumption. Warehousing in Mundra, accounts for about 20% of required logistics market and is expected to grow at a rate of 35 to 40% annually, displaying high potential for growth over the next few years. From a mere combination of transportation and storage services, logistics is fast emerging as a strategic function that involves end-to-end solutions that improve efficiencies. Increasingly, warehouses are being used to serve several important functions, beyond mere storage of products, requiring warehouse service providers to expand their scope to include more sophisticated services.

In the changing market scenario mass awareness initiatives need to be identified to reveal the importance of PRIME LOCATION warehousing, career opportunities AND HIGH RETURNS in this sector.

Mundra's warehousing technology market is growing steadily, with the upswing in demand from the import-export logistics, retail, and manufacturing sectors, as well as through government promotion.

## Highlights ....

- **FAST GROWING**  
Extra-ordinary Location  
Just 3.6 kms. from  
Adani Port & SEZ
- Sizes : from 10000 sq.ft.  
Ware house PLOTS available
- Bank Loan Facility Available
- Safe for Investment Also....



PROPOSED\ COMMERCIAL\ LAYOUT\ PLAN\  
\ AT-\ ZARPARA,\ TAL-\ MUNDRA,\ DIST-\ KU

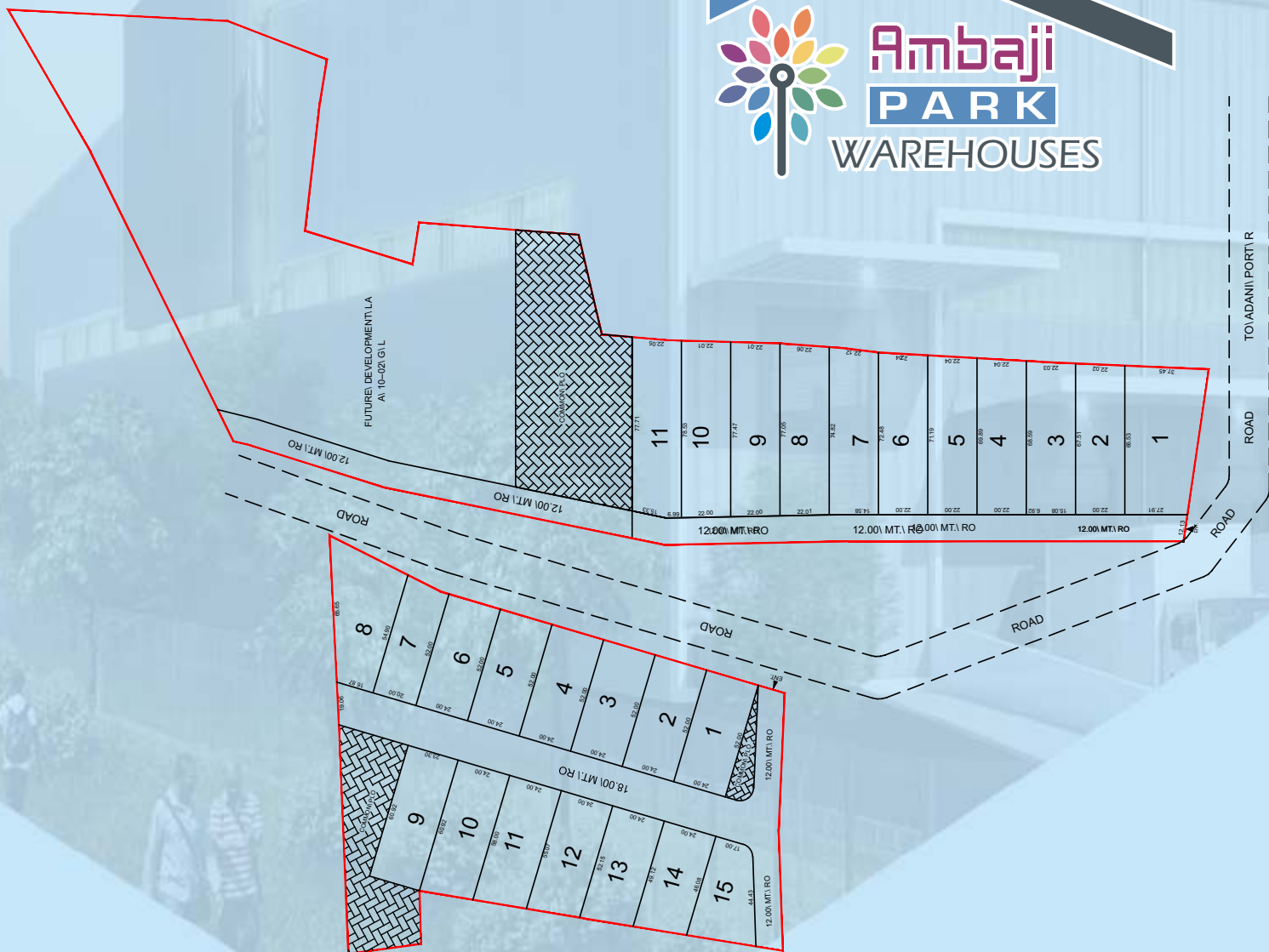

## Area Table

### PHASE-1

AMALG.R.S.NO-269V		
AREA\ TABLE		
PLOT NO.	PLOT AREA SQ.MT.	PLOT AREA SQ.YD.
1	2149.90	2571.28
2	1474.51	1763.51
3	1496.38	1789.67
4	1523.28	1821.84
5	1551.82	1855.98
6	1580.37	1890.12
7	1623.37	1941.55
8	1672.88	2000.76
9	1706.74	2041.26
10	1730.13	2069.23
11	1734.16	2074.05

### PHASE-2

AMALG.R.S.NO-272V		
AREA\ TABLE		
PLOT NO.	PLOT AREA SQ.MT.	PLOT AREA SQ.YD.
1	1248.00	1492.60
2	1248.00	1492.60
3	1248.00	1492.60
4	1248.00	1492.60
5	1248.00	1492.60
6	1248.00	1492.60
7	1062.85	1271.17
8	1579.49	1889.43
9	1419.44	1697.64
10	1427.04	1706.74
11	1356.84	1622.78
12	1286.64	1538.82
13	1215.24	1453.43
14	1142.40	1366.31
15	1066.22	1275.20

### SITE\ PLAN

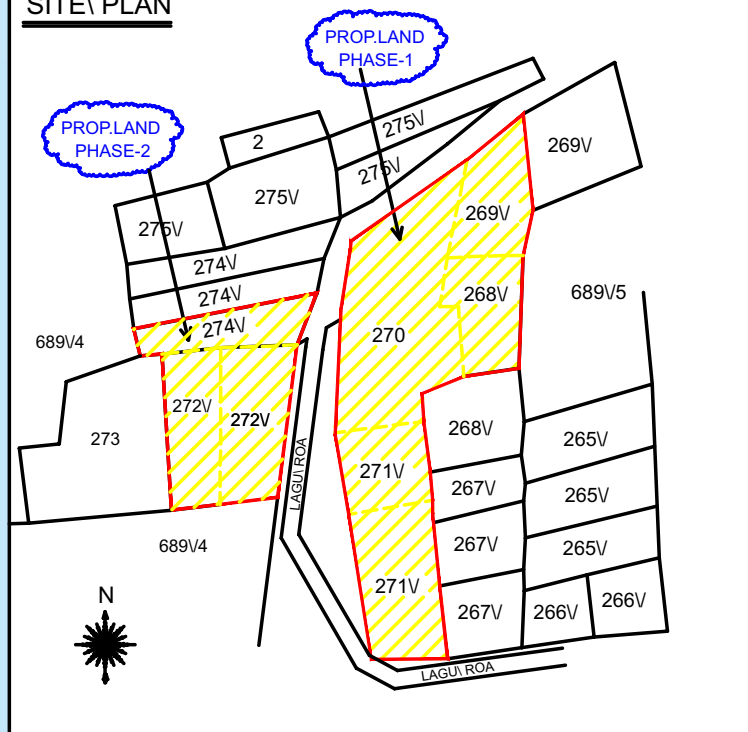



# Location Plan

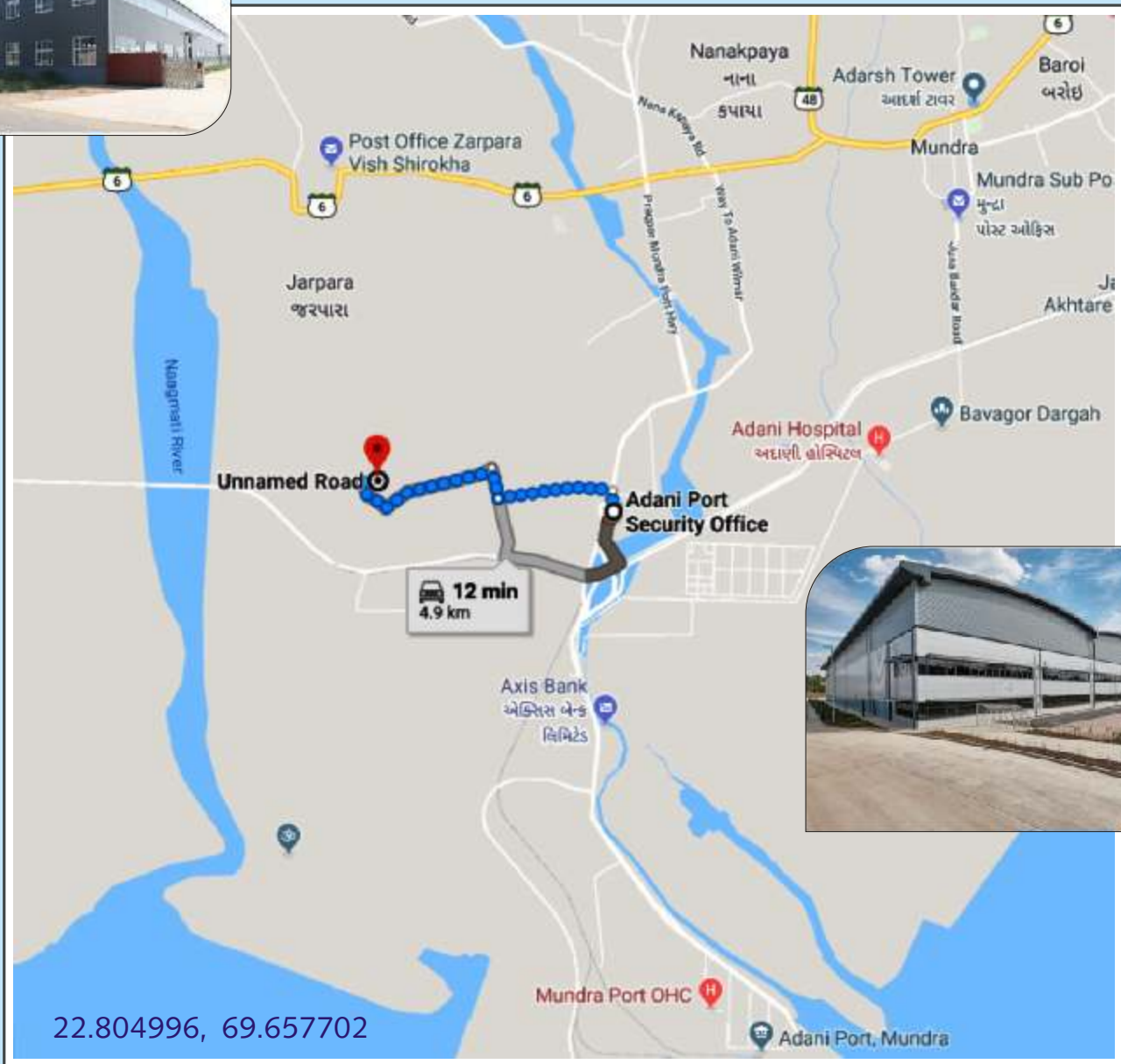

Adani Port Main Gate - Ambaji Farms (Warehouses-Plots) 3.8 km.

For Purchase / Further Details : ...

## Contact

Mr. Manoj Singh Jadoun  
+ 91 - 98251 37552

Mr. Hemant (Danny) Shah  
+ 91 - 98252 27740

Mr. Prashant Sharma  
+ 91 - 98980 69270



Regd. Office :  
"Akshat House",  
Plot No. 220, Sector 1-A,  
Gandhidham - Kachchh - 370 201.